



Providing prestige in professional land planning and design."

Joan Corson Butterfly Garden Wheeling, West Virginia

Services:
Pre-Design
Schematic Design
Master Plan
Bidding or Negotiation
Construction Observation

Role: Prime

Project Size: .13 acres

Project Cost: \$53,500

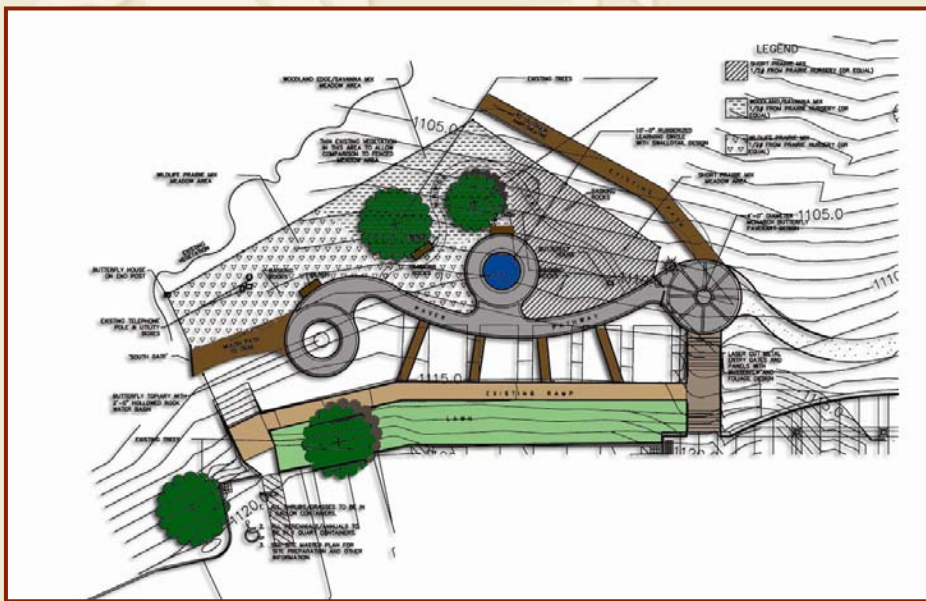

The Oglebay Institute in collaboration with a donor family and the Wheeling Park Commission contracted with Hays LAS to redesign a Butterfly Garden at the Schrader Center for Environmental Education.

The project's focus was to provide an outdoor classroom for learning about butterflies and enjoying the beauty of both the insect and the plants that attract them. The focal point of the garden is a rubberized learning circle for children to sit and learn.

The plantings on one side of the center walk are designed specifically for differing butterfly species, while the other side of the walk is planted as a wildflower meadow. A natural stone sculpted with a water basin serves as the focal point at the end of the garden. Iron butterfly gates grace the entrance to the garden where a new ADA walk has been constructed. In just the first year of the garden's existence, a young girl identified a species of butterfly never before seen in the Wheeling region!