



**Services:**  
Interpretation and Historical Referencing  
Conceptual Design

**Role:** Sub Consultant

**Project Size:** NA

**Project Cost:** NA

*Providing prestige in professional land planning and design."*

## Illinois National Road Interpretive Master Plan

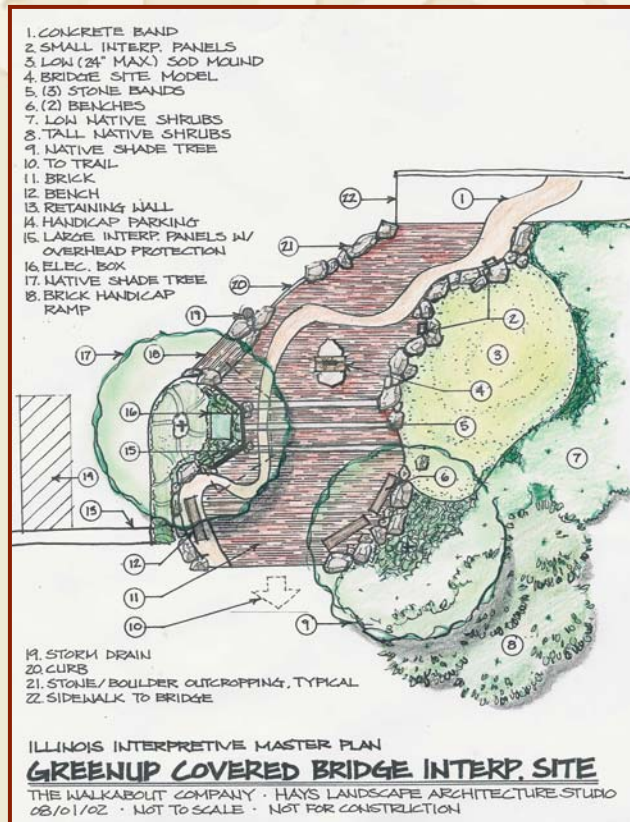

Hays LAS worked on the National Road IMP in Illinois as part of a multidiscipline team of interpretation specialists, marketing experts, geologists, and cultural historians to create a visitor experience for what has become an ALL AMERICAN ROAD scenic byway.

Led by The Walkabout Company, this endeavor provided a unique blend of talented people to address the diverse issues that scenic byways present.

The project consists of evaluating the route from Terre Haute, Indiana to St. Louis, Missouri.

Project team tasks included determining the intrinsic qualities of the corridor, producing examples of interpretive materials, creating a seamless presentation, tracking byway resources in a Geographic Information System (GIS), and formulating a five-year master plan.